



LOA	14.31 m 46'9"
Hull length	14.19 m 46'7"
LWL	12.60 m 41'4"
Beam	4.46 m 14'8"
Draft	2.35 m 7'7" (standard) 2.60 m 8'6" (option) 1.95 m 6'5" (option)
Displacement	approx. 12.2 t approx. 26,932 lb
Ballast	approx. 3,550 kg approx. 7,837 lb (standard)
Engine	39 kW / 55 HP
Fresh water	approx. 380 l
Fuel tank	approx. 250 l
CE Certificate	A (ocean)
Mast length above WL	approx. 24.43 m approx. 80'2"
Total sail area	approx. 124 m ² approx. 1,334 sq ft
Main sail	approx. 67.50 m ² approx. 727 sq ft
Self-tacking jib	approx. 48.30 m ² approx. 520 sq ft
Genoa 105%	approx. 56.50 m ² approx. 608 sq ft (option)
Gennaker	approx. 170.00 m ² approx. 1,830 sq ft (option)
Rig	I 20.00 m 65'7" J 5.32 m 17'6" P 20.00 m 65'7" E 5.70 m 18'8"
Design	judel / vrolijk & co
Interior	HanseYachts Design

Model year 2010/2011 – valid from August 1st, 2010

STANDARD

OPTIONS

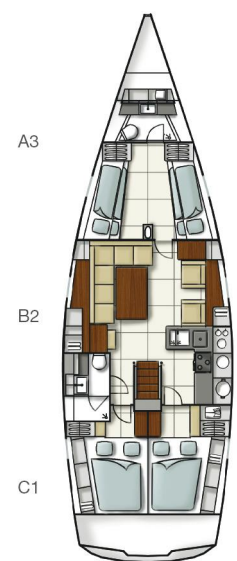
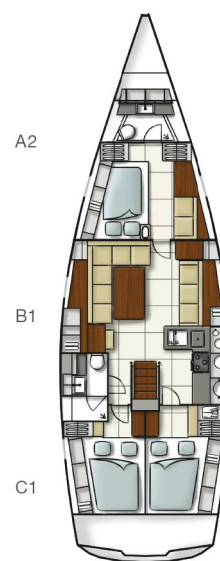
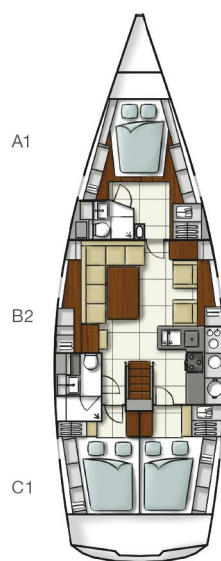
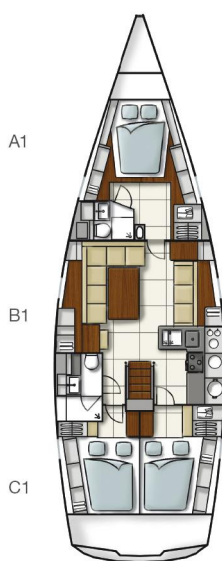

Hull

- White hull
- Dark grey double waterlines
- Options for different hull colours according to Hanse colour selection
- Isophthalic Gelcoat
- Vinylster for all outer laminates until the sandwich
- Polyester inner laminate (Orthophtalic or DCPD)
- Bulkheads laminated to hull and deck
- Strongbacks, galvanized steel
- Hull windows

Deck

- White Deck
- Isophthalic Gelcoat
- Vinylster 1st layer
- Bulk laminate Polyester (Orthophtalic or DCPD)
- Balsa sandwich

Steering System

- Twin wheel steering system
- 2 leather covered steering wheels
- Semi-balanced, profi led rudder with alloy shaft and self-aligning needle bearings
- Emergency tiller

Keel

- Standard: medium draft T shape keel: 2.35 m / 7'7"
- Option: composite iron / lead Performance draft: 2.60 m / 8'6" L Shape
- Option: shallow composite iron / lead draft L shape keel: 1.95 m / 6'5"
- Stainless steel keel bolts

Deck Equipment

- Bow fitting with anchor roller
- Padeye for gennaker – additional item
- Self-draining anchor locker with lockable hatch
- Electric windlass under deck
- Self-draining cockpit
- Teak on seats
- Option Teak on side and deck partly on coach roof
- 5 hatches
- Stainless steel and acrylic glass cockpit table with chart plotter bracket
- 6 retractable mooring cleats
- Hinged swimming platform
- Stainless steel swimming ladder
- Self-draining cockpit
- Engine control at starboard helm stations
- Storage for gas bottle, selfdraining
- Hot & cold shower on aft deck
- Mainsheet on coach roof - Midboom sheeting with 2 stand-up blocks
- 2 x 6 sheave deck organizers
- 12 Halyard Stoppers
- Opening portholes in cockpit
- Stainless steel pushpit with navigation light
- Stainless steel split pulpit with navigation lights
- Stainless steel stanchions tapered
- 4 winches in cockpit:
 - 2 primary winches 54 AST
 - 2 secondary winches 46 AST

Technical System**Plumbing System / Fresh Water****Tank**

- Fresh water tanks, capacity approx. 380 l
- Water infl ll on deck

Hot water

- Water heater, running from engine and immersion heater 230 V

Draining Pumps**Bilge pumps**

- 1 manual bilge pump
- 1 electric bilge pump with automatic switch

Toilet / Head

- 2 manual marine toilets
- stainless steel holding tank with sea and deck discharge for each toilet

Engine

- Volvo D2-55, 39 kW / 53 HP, diesel engine
- Saildrive
- 2 bladed fixed propeller
- 12 V / 80 Ah AGM engine battery
- Fuel tank, capacity approx. 250 l
- Fuel inflill on deck
- Seawater strainer
- Fuel filter / Water separator
- Revolution counter
- Engine hour meter
- Engine mechanical compartment sound insulated

Electric System

- 12 V and 230 V

Batteries

- Main battery switch
- 1 engine battery: 12 V / 80 Ah AGM
- 2 service batteries: 12 V / 150 Ah AGM each

Battery charger / Shore power

- 230 V shore supply protected with differential breaker and distribution system
- Battery charger 50 A

Electric switch panel 110 V / 230 V

- 1 differential breakers
- Control gauge

Electric switch panel 12 V

- Switches for all onboard electrics
- Voltmeter and battery control
- Water / Fuel gauges

12 V Electric equipment

- Electrical anchor windlass
- Pumps
- Navigation lights LED
- Interior lights
- Refrigerator

Sockets 110 V or 230 V

- in fwd. cabin
- in aft cabin
- at chart table
- in galley
- in head

Outlets 12 V

- at chart table
- at helm station

Interior lighting

- Overhead lighting in cabins, saloon, galley and heads
- Lighting in engine compartment
- Reading lights in saloon and cabins

Navigation lights, all LED

- Navigation lights on pulpit and pushpit
- Steaming light
- Anchor light

Navigation instruments

- Compass illuminated
- Speedometer and depth sounder
- 1 Combi display at starboard side

Galley

- Solid surface, Corean™ black quartz with integrated double sink
- 2-burner LPG stove with oven, gimbed
- Gas system and self draining LPG bottle storage in cockpit
- Extra large 12 V fridge of approx. 130 l, top and front loader with light
- Lockers and drawers
- Waste bin

Interior Accommodation

- High quality marine plywood, mahogany veneer, satin varnish
- Option: Cherry or beech satin varnish
- Option: high gloss finish
- White bulkheads
- Wooden door frames
- Wood / Sandwich doors
- Teak styled floor squares in the saloon, individually to be opened
- the optional pricelist shows an alternative floor to our standard teak

Upholstery

- According to Hanse colour selection

Forward cabin

- Version A1
- Owner cabin with "island" berth, extensive hanging lockers and drawers including a head and shower unit in owners state room
- Options according to Hanse Individual Cabin Concept

Main Saloon

- Version B1 standard version
- Large saloon table
- Lockers
- large bench on starboard side
- L-Sofa
- Options according to Hanse Individual Cabin Concept

Navigation area

- Seat at navigation station
- Locker above chart table for instruments and books
- 230 V / 12 V socket
- Storage in the chart table
- Chart light

Aft cabin

- Version C1
- 2 double aft cabins with lockers

Interior Concepts

- Different layouts, according to Hanse Individual Cabin Concept

Head / Shower

- Large head with separate shower stall on port side
- Marine toilet
- Holding tank
- Sea and deck discharge
- Corean™ solid surface black quartz with sink
- Electrical drain pump
- Mirror
- Locker & shelves
- Opening hatch

Rigg and Sails

- 3 spreader silver anodised mast, tapered
- Boom with 2 reefing lines
- Cockpit light in boom
- Mainsail fully battened
- Self-tacking jib
- Furling system for jib
- Main halyard
- Jib halyard
- Main Sheet
- Jib sheet
- Rod kicker
- Backstay adjuster